

- 1 Chapel
- 2 French Garden
- 3 French Pavilion
- 4 Queen's Theatre
- 5 Rock

- 6 Belvedere
- 7 Grotto
- 8 Jussieu's Orangery
- 9 English Garden
- 10 Temple of Love

- 11 Queen's House
- 12 Marlborough Tower
- 13 Dairy
- 14 Mill
- 15 Boudoir

- 16 Warming Room
- 17 Farm
- 18 "Plat-Fond" Basin
- 19 "Buffet d'Eau" Fountain
- 20 Amphitheatre

- P** Parking
- Toilets
- Tickets and information
- Café
- Take away
- Telephone
- Disabled facility

- Refreshments
- Mini-train
- Souvenirs
- Confectionery
- Dogs not allowed
- Bicycles not allowed

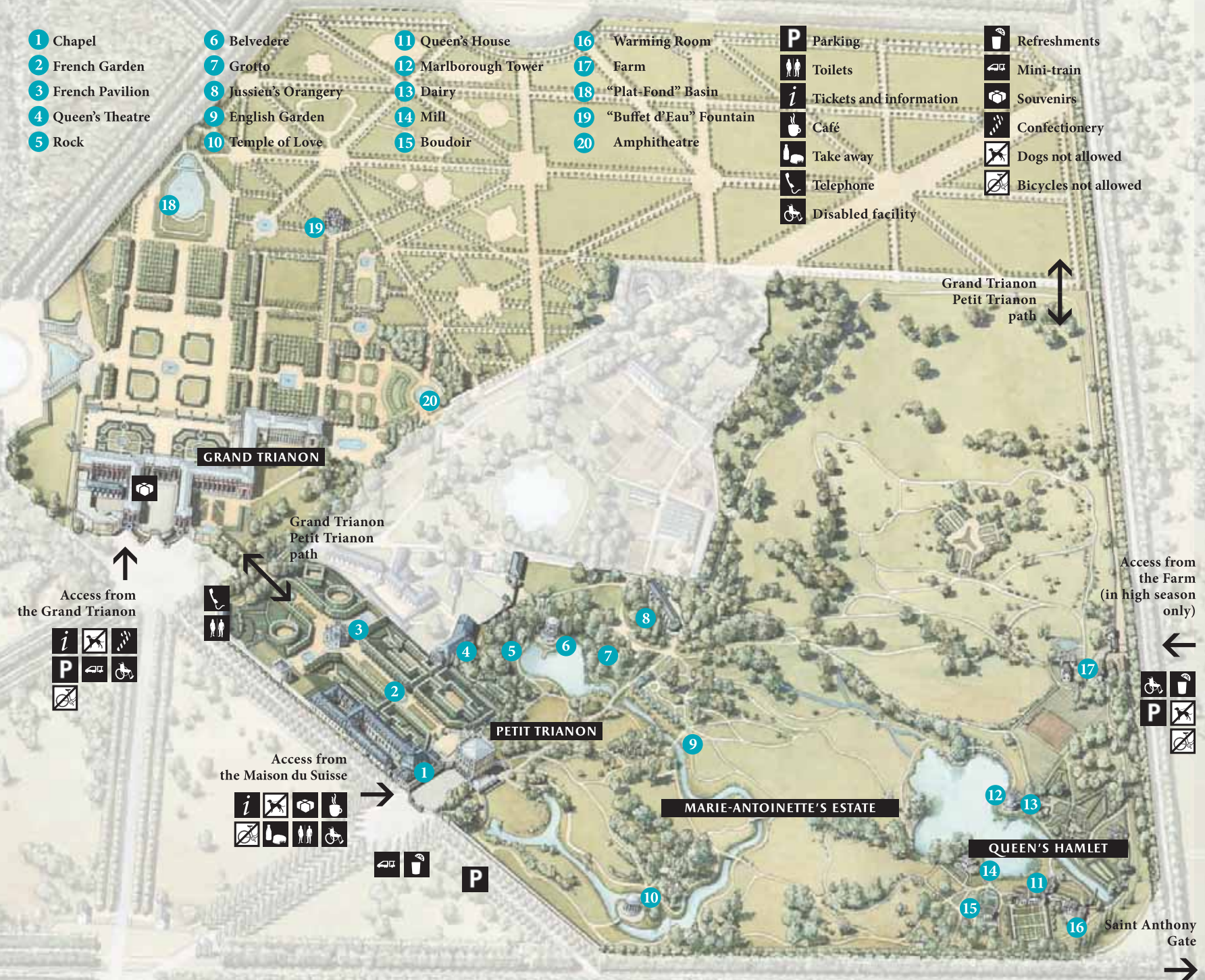

**GRAND TRIANON**

Grand Trianon  
Petit Trianon  
path

**PETIT TRIANON**

**MARIE-ANTOINETTE'S ESTATE**

**QUEEN'S HAMLET**

Grand Trianon  
Petit Trianon  
path

Access from  
the Farm  
(in high season  
only)

Saint Anthony  
Gate

↑  
Access from  
the Grand Trianon

↙

→  
Access from  
the Maison du Suisse

←

→

- 
- 
- 
- P**
- 
- 
- 

- 
- 

- 
- 
- 
- 
- 
- 
- 
- 

- 
- 

**P**

- 
- 
- P**
- 
-